

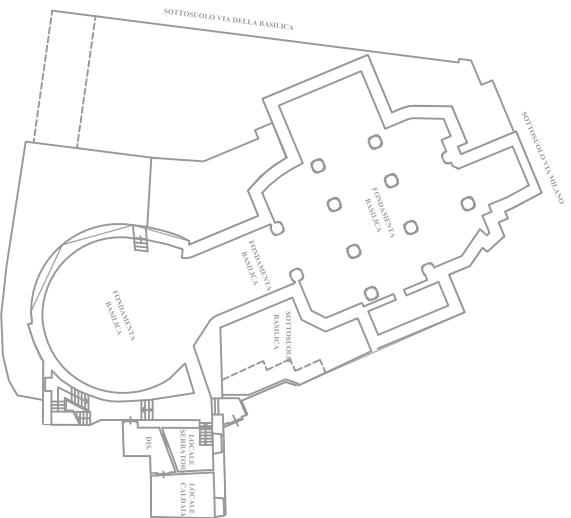

Piano primo interrato

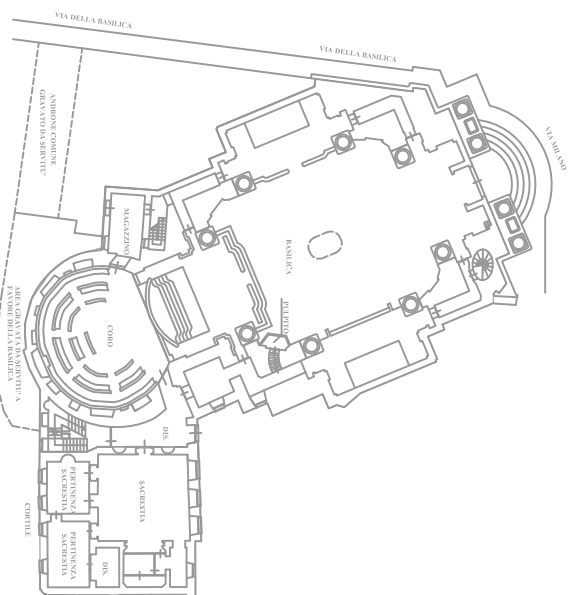

Piano terreno



Piano primo (2 P.F.T.)

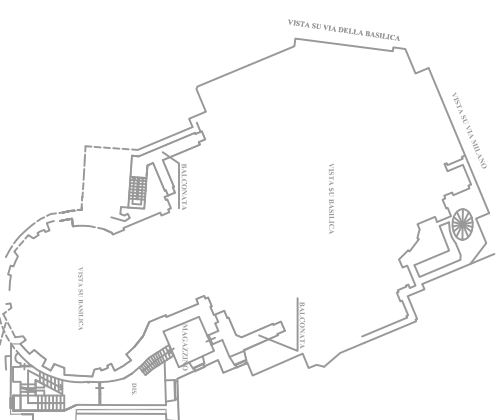

Sezione A-A

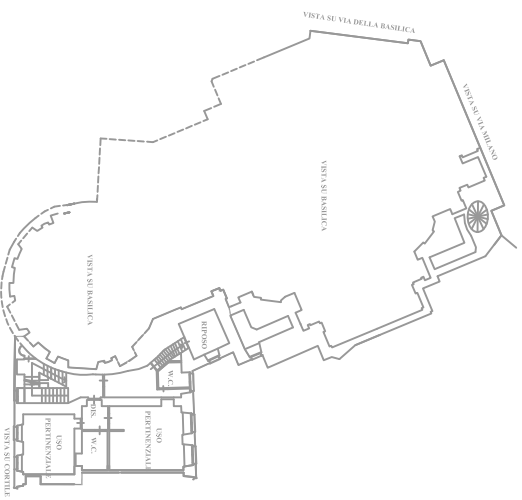
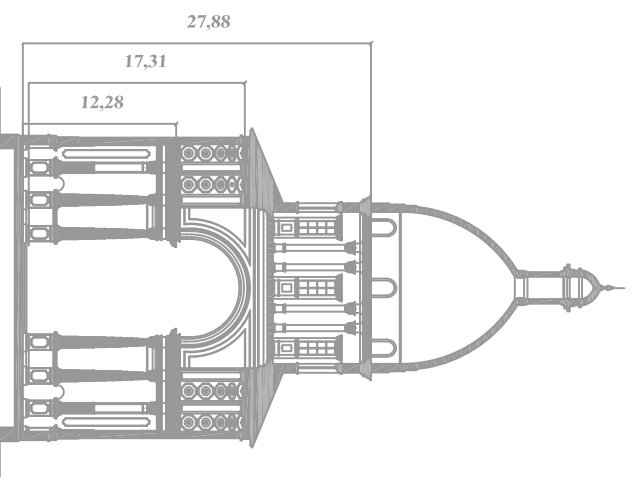

Piano secondo (3 P.F.T.)

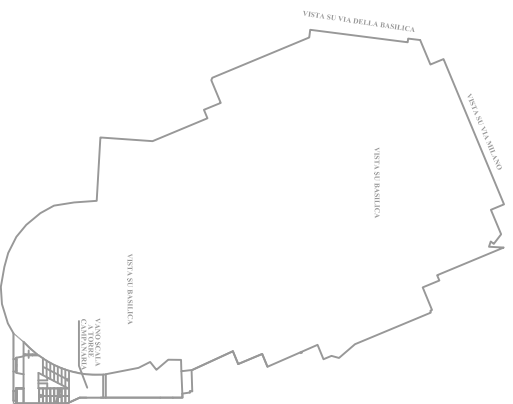

Piano terzo (4 P.F.T.)

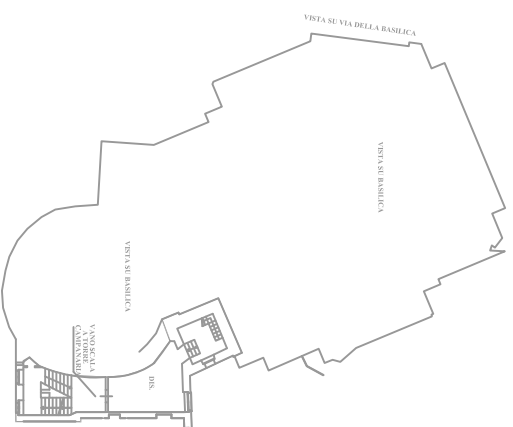

Piano quarto (5 P.F.T.)

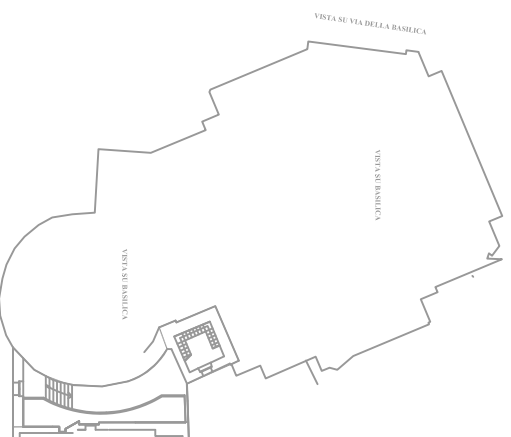

Piano quinto (6 P.F.T.)

Denominazione	Area	Altezza	Volume
Piano primo interrato	693,62	4,30	2.982,56
Piano terreno	757,54	12/17/27	13.977
Piano terreno(sacrestia)	148,96	4,30	417,08
Piano primo (2 p.f.t.)	85,51		
Piano secondo (3 p.f.t.) appartamento	170,53	2,80	477,48
Piano terzo 4 p.f.t.)	22,64		
Piano quarto (5 p.f.t.)	80,53		
Piano quinto (6 p.f.t.)	78,89		
Piano quinto (6 p.f.t.)	2.038,22		17.854,12